

What is AQUASTRAP?



Fig. 1

Referring to Figs. 1-3, Aquastrap comprises of:

- 1) Flexible EPDM Up-stand
- 2) EPDM Isolating Membrane
- 3) Butyl Adhesive Isolating & Alignment Cord
- 4) High Tack Butyl Adhesive
- 5) Lower Butyl Release Liner
- 6) Upper Butyl Release Liner

Aquastrap is supplied with alcohol wipes and butyl adhesive endcap foam cords.



Aquastrap forms a continuous flexible up-stand around shower trays and baths.

Fig. 3

Sealux Ltd. UK Tel: 0870 8760121 Fax: 0870 8760119
 Ireland Tel: 01 298 9121 Fax: 01 298 9119
 Website: www.aquastrap.com Email: info@sealux.com
 Aquastrap is patented and a registered trademark.

We reserve the right to add, withdraw or modify the range without notice.
 Product liability is limited to product replacement.

'AQUASTRAP and the Building Standards'

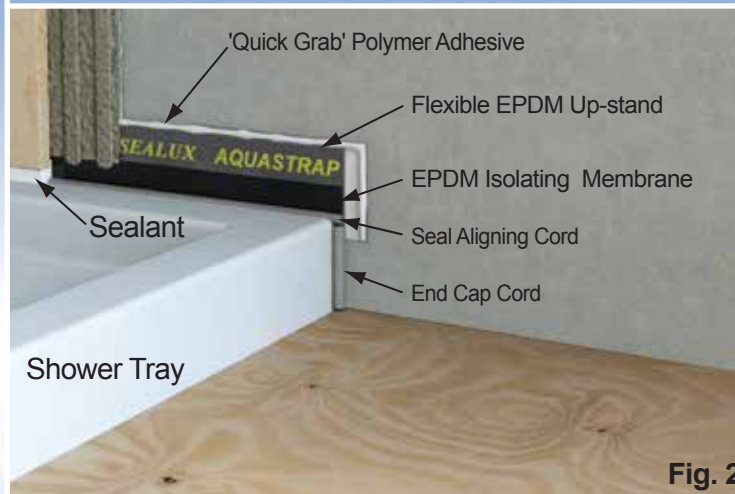

Fig. 2

The following references to 'codes of practice' are offered as guidance on best practice and are not specifications that must be met. We ask you to consider the merit of these codes and benefit of compliance in the context of the product supplied. Please refer to above drawing.

BS6213:2000 Section 4.5.3 advises consideration is given to specific substrate compatibility characteristics which may exist prior to sealant installation (e) sealant discoloration which may occur from contact with other polymeric construction components within the joint. Appropriate substrate preparation is recommended.

The manufacture of Aquastrap incorporates the application of sealant isolating materials onto those polymeric parts of the flexible up-stand and high tack butyl adhesive liable to come in contact with sealant when applied into the joint between the tile and ledge after product installation.

Aquastrap is thus prepared and supplied to installers already in compliance with the above BS6213:2000 Section 4.5.3 recommendation, relieving installers of the necessity to retrospectively prepare 'sealant' reactive substrates as advised by the British Standards.

BS6213:2000 also refers to ISO 11600 as a means of identifying suitable sealants which meet a number of requirements, in particular movement accommodation.

Sealux-N silicone conforms to ISO 11600 F+G-25 LM
 High Tack Adhesive was tested to ISO 8510-1 1990



SELF-ADHESIVE FLEXIBLE WATERPROOF UP-STAND

Shower Trays - Baths - Worktops



AQUASTRAP
 'Intelligent
 By Design'

Why choose Aquastrap?

- ✓ **Sealant isolating membranes** pre-applied onto the EPDM up-stand and butyl adhesive save installers time and ensure conformity to BS6213 recommendations as detailed on the adjacent page.
- ✓ **A seal alignment cord** bonded onto the butyl adhesive offers a clearly defined 'tack free' aligning edge for perfect positioning.
- ✓ **Two butyl release liners** facilitate an easier and superior 'hang & bond' installation method for both new and seasoned installers!

Standard Lengths. 2.0 Mtr, 2.3 Mtr, 2.8 Mtr, 3.4 Mtr, & 4.0 Mtr Rolls.
 Other roll lengths available upon request

Installation Instructions

Installation video on www.aquastrap.com
 (Apply the same procedure for a bath or worktop)

- (1)** Roughen side walls with wire wool and clean surfaces with alcohol wipes.
- (2-3)** Unroll Aquastrap the length of the first side wall and 200mm beyond corner. Peel back upper release liner (c) 100mm. Keep the top of the aligning cord (a) level with the top of the ledge (e) while using the thumb to press the exposed adhesive face onto the adjacent side wall. For very rounded corners refer to fig.17.
- (4)** Continue process until first side is complete removing liner (c) 150mm beyond corner.
- (5-6)** Lift up the lower part of Aquastrap (d) at a right angle to the side wall and peel off (pulling downward) the lower release liner (b) 150mm beyond corner.
- (7)** Press the lower adhesive face (from top down) against the side wall expelling potential air pockets in the process.
- (8)** If shower tray or bath has rounded corners, the adhesive should be pinched (bulked up) to maintain 90° angle around corner.
- (9-11)** Continue installing Aquastrap onto remaining side walls in a similar fashion.
- (12)** We suggest using a seam roller to ensure full contact between adhesive tape and side walls.
- (13)** Cut foam strip 45mm long and cap adhesive ends as shown.
- (14)** Once the shower tray/bath is located in position, bond that part of Aquastrap extending above the ledge to the adjacent wall with a polymer adhesive.
- (15-16)** Apply Sealux-N into the tile/ledge joint.



The position of the seal aligning cord (blue) on the shower tray/bath side wall is determined by the radius of the ledge/side wall corner. Installers should align Aquastrap at a level on the side wall that ensures the seal aligning cord forms a pressure seal between the up-stand on one side and the side wall on the other side and so prevent contact between the silicone (yellow) and butyl adhesive (red). Use Sealux-N or equivalent neutral curing silicone between the tile and ledge.

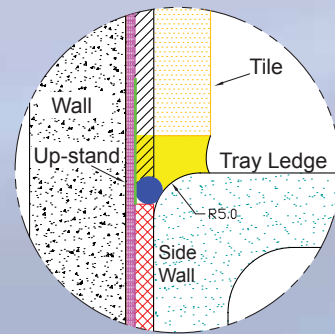

Fig. 17A. Aquastrap Detail (ledge radius 5mm)

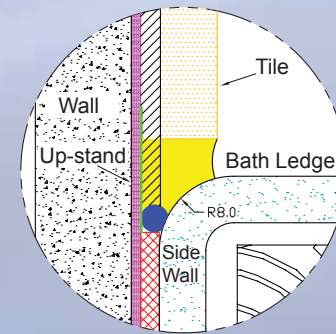

Fig. 17B. Aquastrap Detail (ledge radius 8mm)

16
 We recommend Sealux-N or an equivalent neutral curing/quality silicone is applied into the tile/ledge movement joint

